

Blind Flanges PN 100

TS ISO 7005-1 - EN 1092-1

Tip 05 / Type 05

DIN 2527

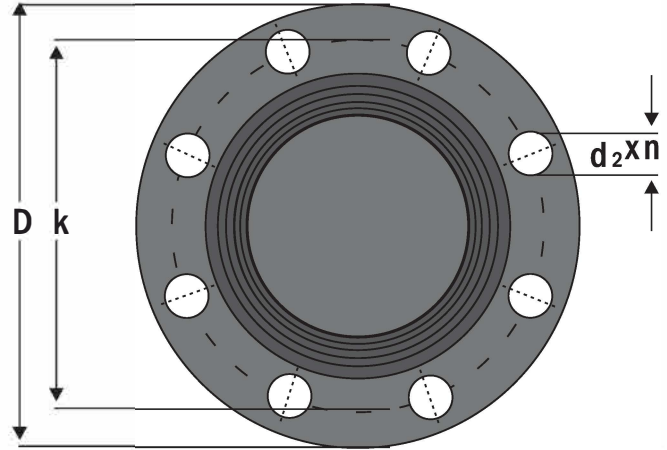
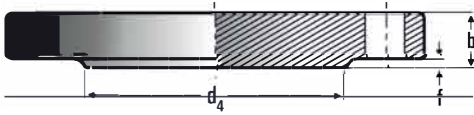

PIPE	FLANGE			Raised Face			Drillings		Weight
DN	D	b	k	d4	f	n	screw	d2	kg
10	100	20	70	40	2	4	M12	14	1
15	105	20	75	45	2	4	M12	14	1,5
20	130	22	90	58	2	4	M16	18	2
25	140	24	100	68	2	4	M16	18	2,5
32	155	24	110	78	2	4	M20	22	3,5
40	170	26	125	88	2	4	M20	22	4,5
50	195	28	145	102	2	4	M24	26	6
65	220	30	170	122	2	8	M24	26	8
80	230	32	180	138	2	8	M24	26	9,5
100	265	36	210	162	2	8	M27	30	14
125	315	40	250	188	2	8	M30	33	22,5
150	355	44	290	218	2	12	M30	33	30,5
200	430	52	360	285	2	12	M33	36	54,5
250	505	60	430	345	2	12	M36	39	87,5
300	585	68	500	410	2	16	M39	42	131,5
350	655	74	560	465	2	16	M45	48	179
400	715	-	620	535	2	16	M45	48	-
500	870	-	760	615	2	20	M52	56	-

Ölçüler mm.'dir. / Dimensions are in mm.